

## Hillsborough Court, Mortimer Crescent, London, NW6

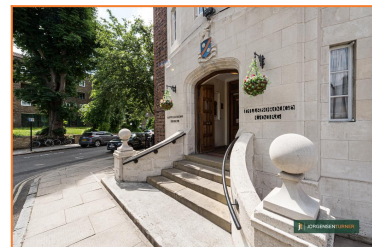

### £395,000 Leasehold

- Two double bedroom purpose built flat
- Central courtyard garden
- Portered building
- First floor with lift
- Set in an attractive Neo-Tudor building
- Recently updated throughout
- 163 year lease remaining

# Hillsborough Court, Mortimer Crescent, London, NW6

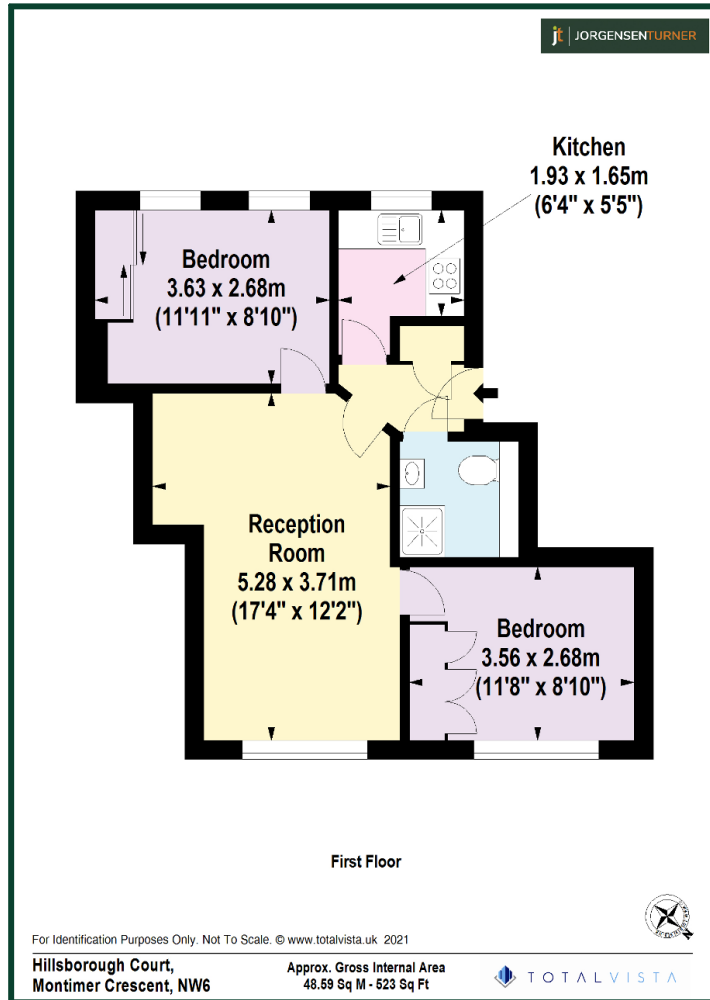

Energy Efficiency Rating			
Score	Energy rating	Current	Potential
92+	A		
81-91	B		
69-80	C		78   C
55-68	D	65   D	
39-54	E		
21-38	F		
1-20	G		

**Viewing:** For further information or to arrange a viewing please call us on the numbers below.

**Disclaimer:** These particulars are thought to be materially correct though their accuracy is not guaranteed and they do not form part of any contract. All measurements are approximate and we have not tested any fitted appliances, electrical or plumbing installation or central heating systems.

Shepherds Bush & Hammersmith Office

020 8740 8740

Queens Park & West Hampstead Office

020 7604 4040

www.jorgensenturner.com