

Chichester House, Chichester Road, Kilburn, London, NW6



£425,000 Leasehold

- Generous two bedroom garden flat
- Reception room leading to private garden
- Close to Bakerloo line tube
- 681 sq ft of accommodation
- Large eat-in kitchen
- Well presented throughout
- Long lease
- Additional storage cupboards

Chichester House, Chichester Road, Kilburn, London, NW6

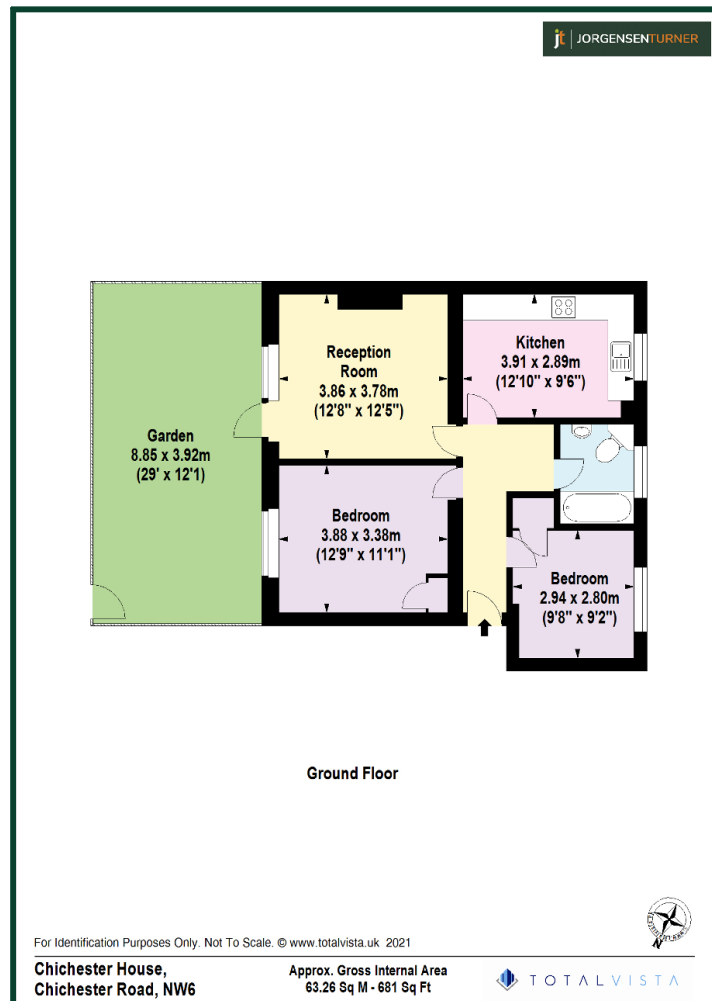

Energy Efficiency Rating			
Score	Energy rating	Current	Potential
92+	A		
81-91	B		
69-80	C	70 C	78 C
55-68	D		
39-54	E		
21-38	F		
1-20	G		

Viewing: For further information or to arrange a viewing please call us on the numbers below.

Disclaimer: These particulars are thought to be materially correct though their accuracy is not guaranteed and they do not form part of any contract. All measurements are approximate and we have not tested any fitted appliances, electrical or plumbing installation or central heating systems.

Shepherds Bush & Hammersmith Office

020 8740 8740

Queens Park & West Hampstead Office

020 7604 4040

www.jorgensenturner.com